

※ Please prepare 1 set of rPi before EVK operation.

Demo Kit Hardware Description



Connector	Function
12V DC CONNECTOR	DC 12V, for TCON power supply
5V DC CONNECTOR	DC 5V MicroUSB, for rPi power supply
LVDS FFC CONNECTOR	Connector for 25.3" ACeP and TCON board
TS BOARD CONNECTOR	Connect to thermal sensor board via 10cm FFC
Micro USB	Connect to the rPi and TCON board

Operating Instructions

① Configure hotspot

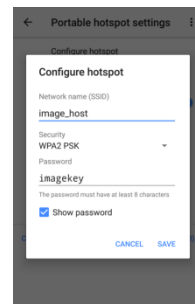

Network name : image_host
Security : WPA2 PSK
Password : imagekey

② Share hotspot

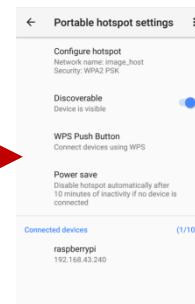

Remember the IP
Example : 192.168.43.240

③ Login rPi

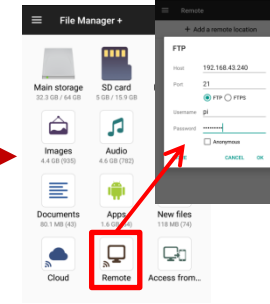

Key-in IP (ex. 192.168.43.240)
Username : pi
Password : raspberrypi
"File Manager+" download from google play app store(Android)

④ Select pictures in mobile phone

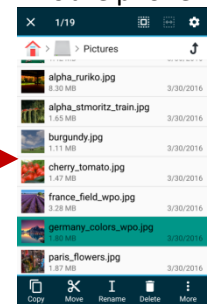

⑤ Upload images selected onto rPi

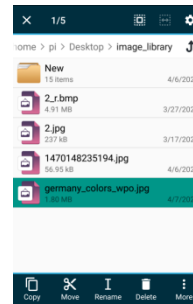

※THE PICTURES MUST UPLOAD AS PATH
File path : `home/pi/Desktop/image_library`

① Open config.txt

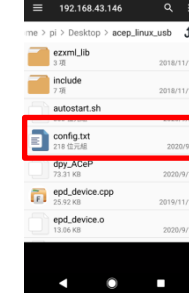

② Edit dwell_time



※THE WAY TO CHANGE THE DWELL TIME
File path : `home/pi/Desktop/acep_linux_usb`